

Early Literacy Programme



Who can use the ELP?

The ELP can be used by volunteers, community workers, or library staff to support young children as they learn to read and write.

A school could use the ELP to train a team of volunteers to work with children who would benefit from extra help. A library or community-based organisation might include the programme in their day-to-day work with children

Programme goals

- Provide targeted support to children in Grades R, One and Two to strengthen their language and early reading and writing
- Empower and equip organisations and schools to support early literacy and language learning
- Provide a structured programme for people who want to give their time to support young children as they learn to read and write

Target group



Children between the ages of 5 and 8 years who are learning to read and write in English or Afrikaans



Older children who have not yet acquired basic literacy skills or are learning to read and write in English as a second language

How the Early Literacy Programme works

- Two volunteer co-ordinators from a school/organisation attend a 2 day training with Wordworks.
- The co-ordinators recruit and train a team of volunteers who commit 2 hours a week to the programme.
- Together with teachers at a school, the co-ordinators select children who will benefit from the ELP.
- Volunteers work directly with two children, while a coordinator provides support and monitors children's progress.
- Volunteers work with the same children for at least six months.

Method and approach

Each session provides children with:

- individual attention and support tailored to their learning needs
- the chance to hear and use rich language
- a fun and stimulating learning environment

Each session follows the same four steps:

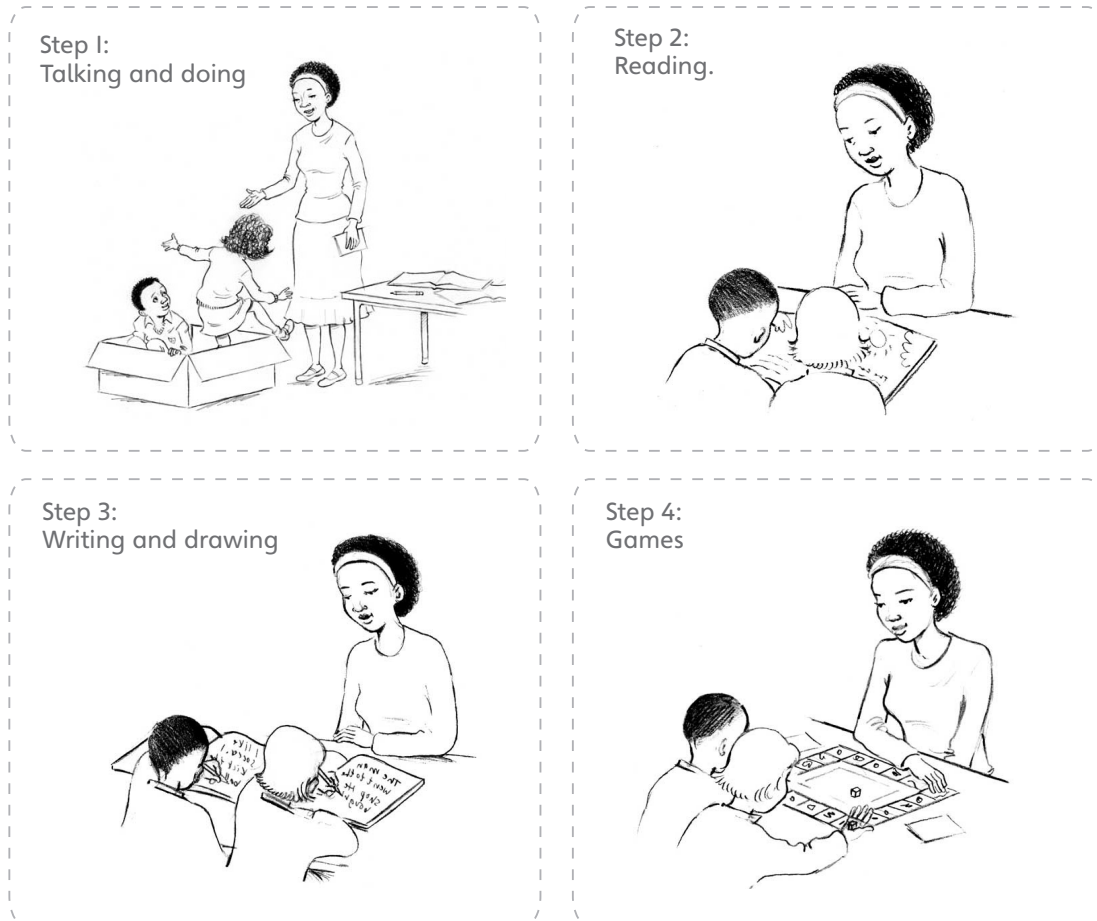

Benefits

Children benefit in many ways from the programme:

- Their language and literacy skills improve.
- Their self-esteem and confidence grow as they experience success.

Volunteers benefit too:

- They have the knowledge and skills to play a meaningful role in supporting literacy in their communities.
- They build relationships with young children and have a chance to 'give back'.

Schools benefit:

- More children learn to read and write successfully!
- Teachers feel supported and can teach without having to go back and help some learners to catch up.
- Fewer children need Learning Support.

“We did drawing and played games. We were learning about sounds and letters. We chose books to read. My favourite thing was to play games and draw and read books. I couldn’t write my work. Now I can. I tell my friends they can learn everything they want to.”

Grade 2 learner

“I have noticed a steady improvement in reading, writing and language but the biggest boost has been the pupils self-confidence – ‘I can do it!’ Their enjoyment says it all.”

Volunteer

“It has been a valuable experience for me because now I know how to teach children and help children to read. There are big improvements in the children’s reading and writing as well as their language. Through this programme we can help others as well as ourselves.”

Volunteer



Resources

To begin an Early Literacy Programme, there are standard resources that are available from Wordworks.

Co-ordinator’s file:

- a training DVD to train volunteers
- a co-ordinator’s handbook and photocopiable resources
- picture sequences and shared games
- an assessment kit and scoring guidelines
- volunteer kits for Grade R and Grade One

Volunteer Kits

Each volunteer will need a kit which includes a manual; board games; dice and counters and picture and word cards to cut out. These kits are available in English and Afrikaans.

Readers and Storybooks

Each ELP site will need a set of graded readers and storybooks to use for the lessons.

Training

Wordworks provides training for two co-ordinators from a school/organisation. The co-ordinators will be equipped to go back to their school/organisation and train volunteers. The initial training for co-ordinators is two days. Training costs will depend on whether co-ordinators attend a cluster training session in Cape Town or whether we set up a training session specifically for your organisation.



What to do next?

Contact us for more information about our training packages:
Email: sue@wordworks.org.za or shelley@wordworks.org.za
Phone: 021-7889233